

### Parts

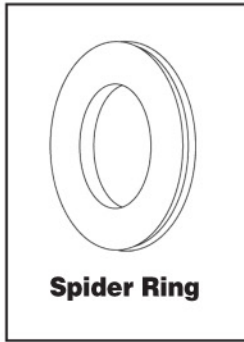

**Spider Ring**

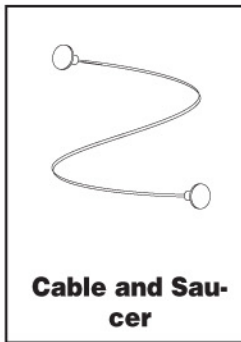

**Cable and Saucer**

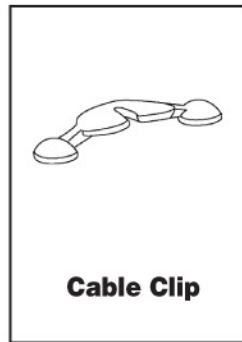

**Cable Clip**

### Instructions for assembly

#### Important note:

Spider Rings can be attached before or after suspending sign. If the rings need to be positioned out of reach, or if more than two cable wraps are required per ring, wrap the cable around the ring before sign is hung.

#### Step 1

Place cable into inner channel of Cable Clip. The cable should snap into place. **Fig. 1**

#### Step 2

Align one end of Cable Clip with top channel of the holder. Insert one round end, then press down on other round end and slide Cable Clip into rail. **Fig. 2**

#### Step 3

Place Spider Ring onto the cable. The cable goes inside the ring's outer groove. **Fig. 3**

#### Step 4

With the cable inside the groove, wrap it once around the ring. **Fig. 4**

#### Step 5

While holding the ring, pull down on cable until it pops into the groove. **Fig. 5** Repeat steps 1-3 for multiple wrappings.

**Note:** Each wrap shortens the cable by 3". Maximum of 10 wraps or 30" per Spider Ring. Multiple rings can be used on each cable for more adjustability.

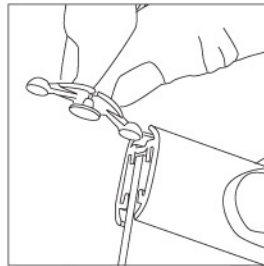

**Figure 1**

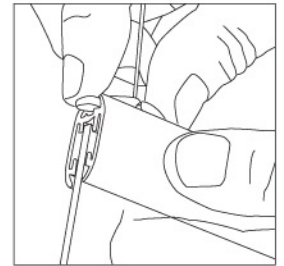

**Figure 2**

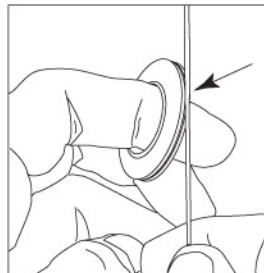

**Figure 3**

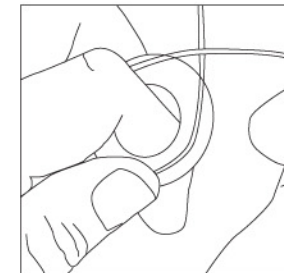

**Figure 4**

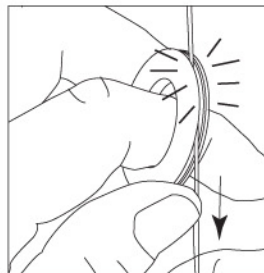

**Figure 5**

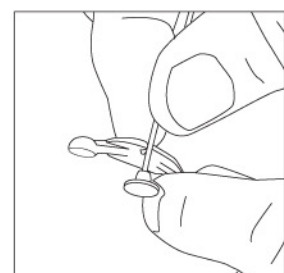

**Figure 6**