

Parts

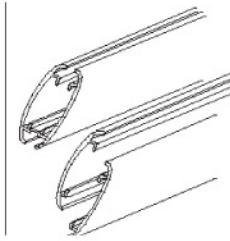

**Corner
Assembly Clips**



**AnoFrame
Round Rails**

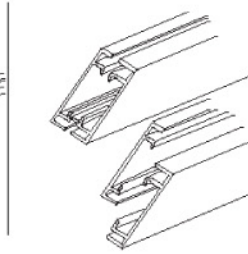

**AnoFrame
Square Rails**

or



Slatwall Hanger

Instructions illustrate a side-load frame. Assembly steps are the same for top-load.

Instructions For Hanging

Step 1

Locate the two split rails and the solid rail that is the same length as the split rails. Insert corner brackets into side AnoFrame rails. Insert two corner brackets into each end of the solid side Ano rail. Insert one corner bracket into each end of each split side Ano rail. **Fig. 1 & Fig. 2**

Note: Tension tabs on corner brackets face towards outside of frame.

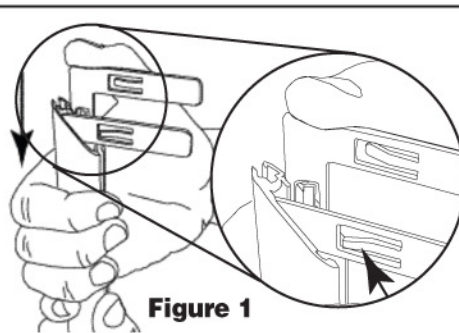

Figure 1

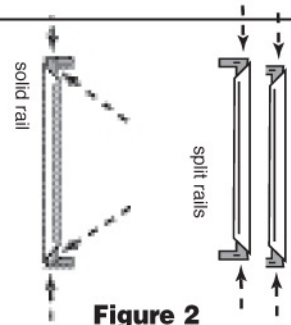

Figure 2

Step 2

Finish assembling frame by following sequence in **Fig. 3**.

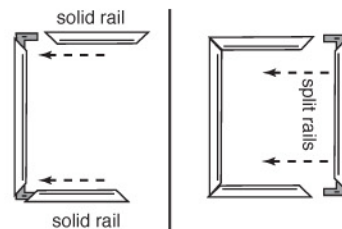

Figure 3

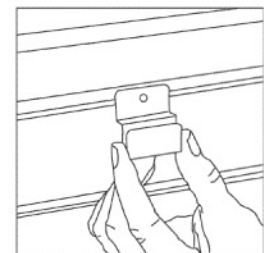

Figure 4

Step 3

Insert hangers into upper portion of slatwall. **Fig. 4**

Note: To ensure that the frame hangs level use two hangers placed an equal distance in from each side of the frame.

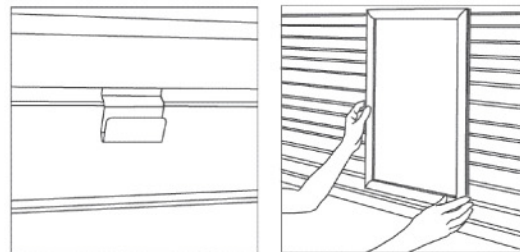

Figure 5

Step 4

Place the AnoFrame on the hangers using the bottom channel of the top Ano rail. **Fig 5**