

Parts

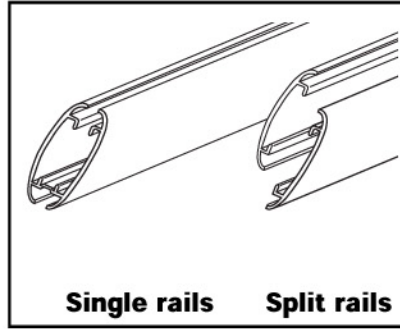
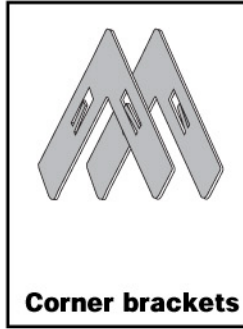
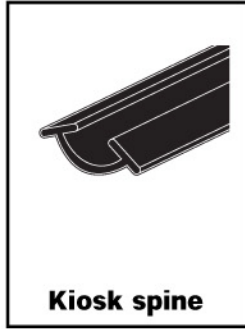
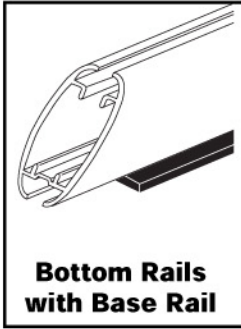

Instructions for Assembly

Note:

We recommended that two people assemble this kiosk.

Step 1a

Slide spine into vertical rail.

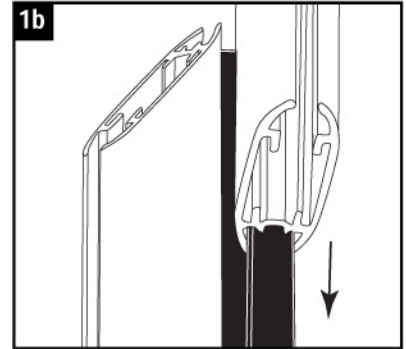
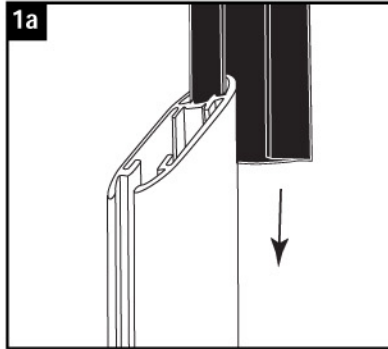

Step 1b

Slide another vertical rail onto the other edge of spine. Repeat for all vertical rails and spines.

Step 2

Carefully insert corner brackets into ends of bottom rails, using thumb as shown in illustration. Two brackets per end of each rail. Bracket can bend if forced.

Detail- It is important that the corner bracket tension tab faces toward outside of frame. (2b)

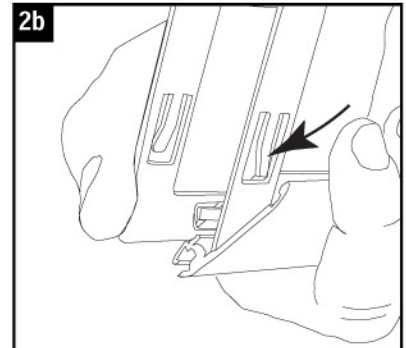
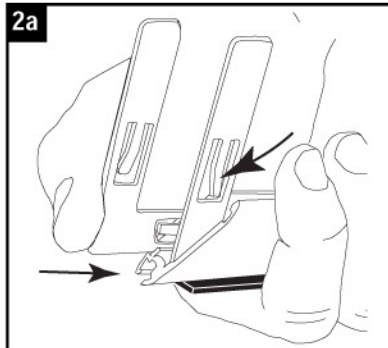

Step 3

Lay out parts as they will be configured on the floor.

Note: One kiosk will have Base Rail other(s) will have stacker bar.

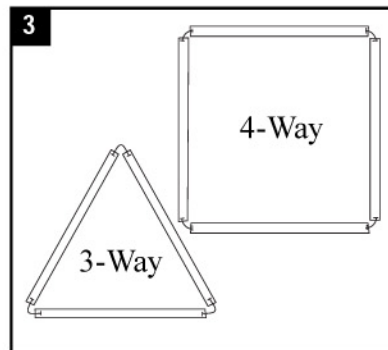

(Continued on other side)

Instructions for Assembly continued

Step 4

Assemble the vertical rail assemblies onto the upward facing corner brackets already inserted into the bottom rails. All four brackets should go into the vertical rails at one time.

Note: (4 way only) The last vertical rail will be tensioned. This is normal.

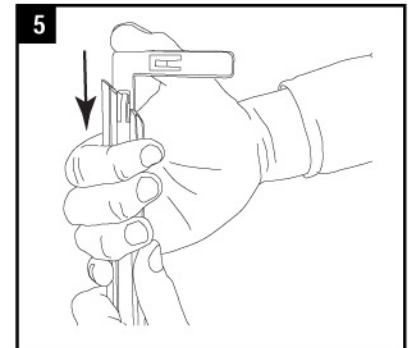
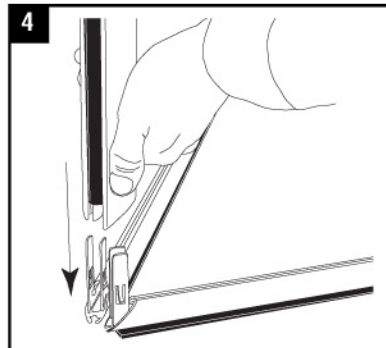

Step 5

Insert corner brackets into ends of split rails, 1 per end. Use thumb as shown in illustration.

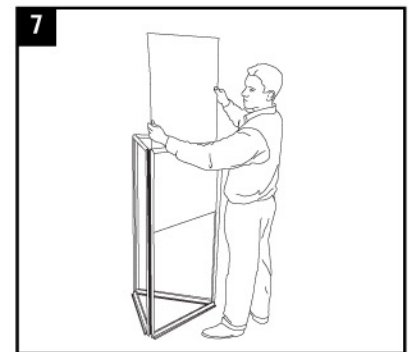
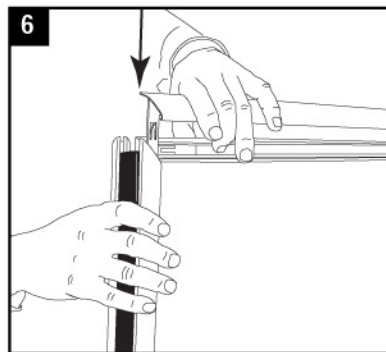

Step 6

Assemble split rails onto top ends of vertical rails, one inside and one outside of each side of the AnoKiosk.

Step 7

Insert graphics into kiosk with Base Rails.

Step 8

Place kiosk with stacker bar on top of first kiosk. Line up stacker bar with split rails on lower kiosk and snap together.

Step 9

Load graphics into upper kiosk.

Step 10

If there are more kiosks to be stacked repeat steps 8 and 9.

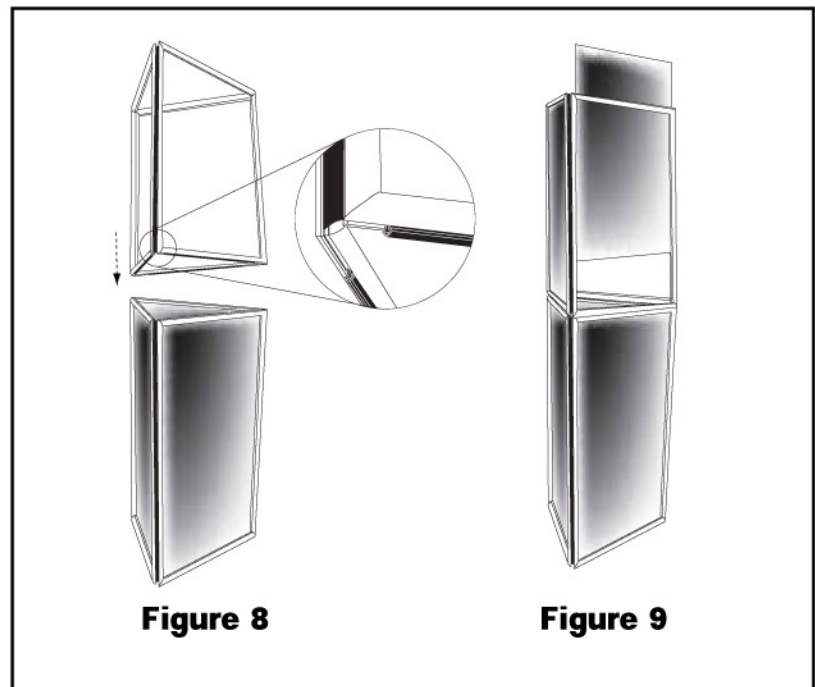

Figure 8

Figure 9