

Parts

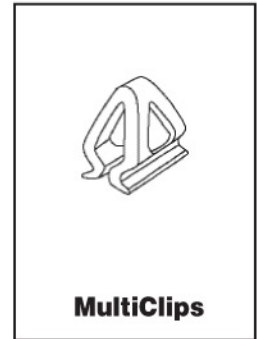
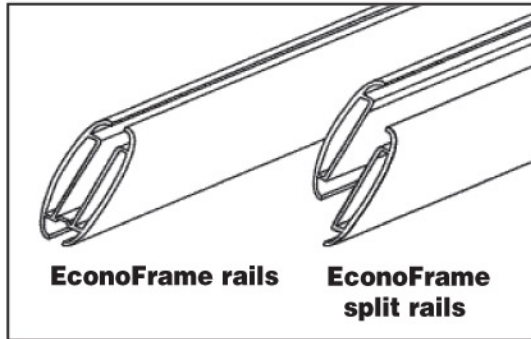
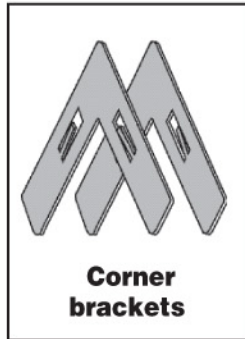

Instructions for Hanging

Step 1

Insert corner brackets into split rails and into rail opposite split rail. Split rail side is made up of two separate pieces. **Fig. 1**

Note: Corner bracket tension tabs must face toward inside of frame.

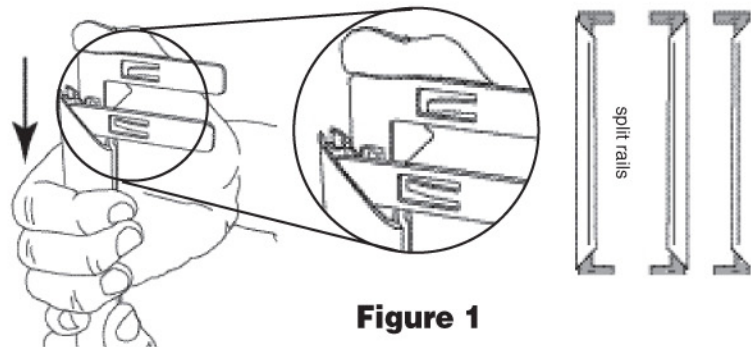

Step 2

Squeeze sides of MultiClip together. **Fig. 2.**

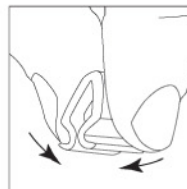

Step 3

Find top rail of frame and align the bottom rail of the MultiClip with the top channel of the top rail. Slide MultiClip into rail. **Fig. 3**

Repeat steps 2 & 3 for second MultiClip.

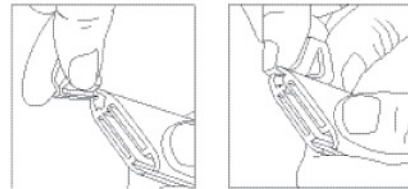

Step 4

Assemble frame following steps in **Fig. 4** sliding sides together in the order shown.

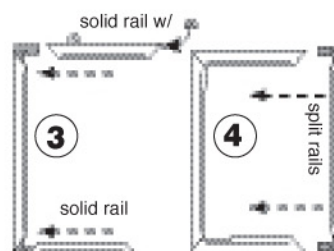

Step 5

Insert poster. **Fig 5.**

