

Telescoping AnoGotcha™ Stand

Instruction Sheet

#97-0500

Parts

Here are all the parts required to assemble 1 Telescoping AnoGotcha Stand.

Read this instruction sheet carefully before assembly. Separate all parts and check quantities. Make sure all parts are accounted for before discarding any packaging materials.

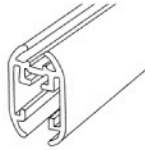

AnoQuick shell with dowel

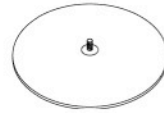

9" round base



vertical poles with telescoping locks

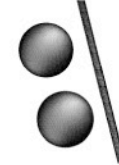

puck knobs & threaded rods



shaped end caps

Important terms:

top AnoQuick holder

vertical post

telescoping locks

ball knobs

bottom AnoQuick holder

11" round base

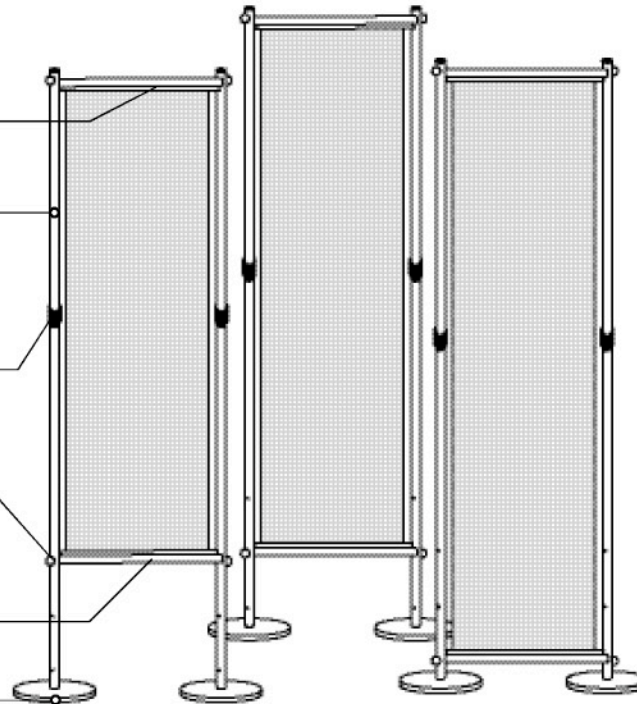

Finished look.

Telescoping AnoGotcha™ Stand *assembly continued*

Step 1 Screw ball knobs onto threaded rods.

- Locate four ball knobs and two threaded rods.
- Screw one ball knob onto one end of each threaded rod.

Note:

Do not screw a ball knob onto both ends of threaded rods.

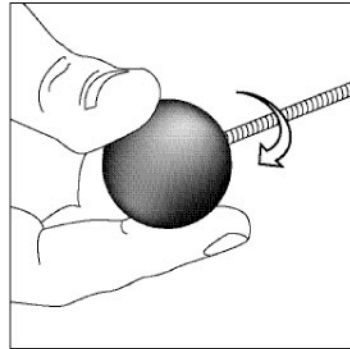

Screw ball knob on one end of threaded rod and tighten.

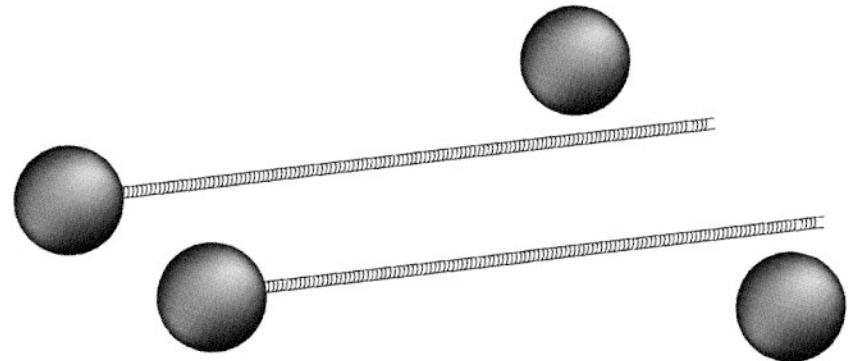

You should now have one ball knob on **one end** of each threaded rod.

Step 2 Screw vertical poles into 11" round bases.

- Screw the end of one vertical pole onto the threaded stud of each 11" round base.
- Repeat for both poles.

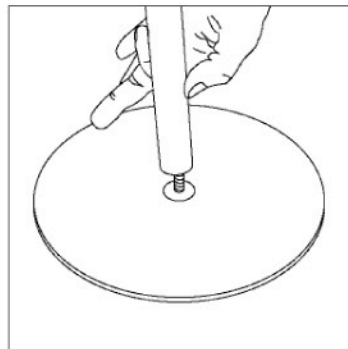

Screw one vertical pole onto each 11" round base.

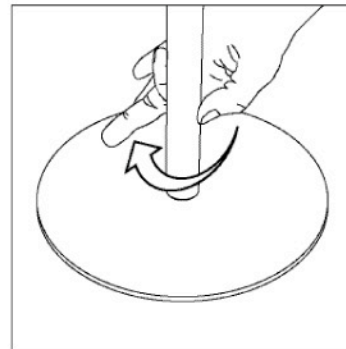

Tighten with hands.

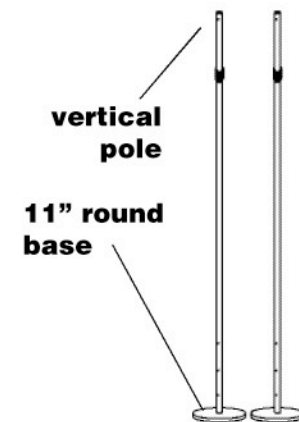

You should have two matching vertical poles with bases.

Telescoping Anogotcha™ Stand *assembly continued*

Step 3 Insert dowel into pocket of graphic and attach end caps.

- Slide dowel into pocket of graphic and insert both into AnoQuick holders.
- Attach one shaped end cap onto each end of both AnoQuick shells.

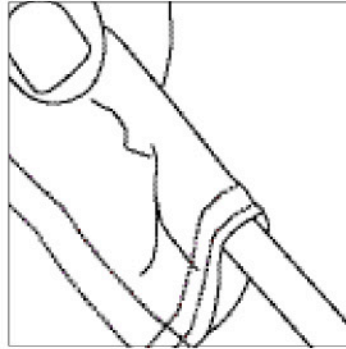

Insert dowel into sown pocket of graphic.

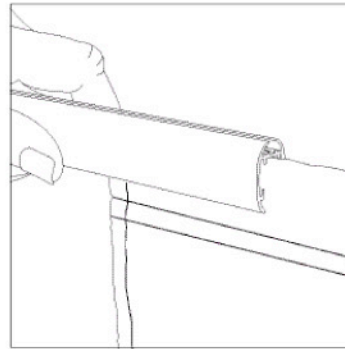

Insert dowel with graphic into AnoQuick holder.

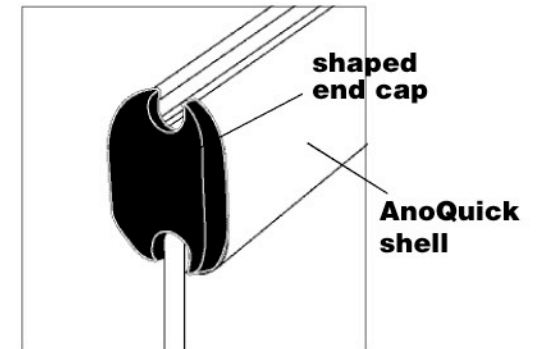

Attach one shaped end cap onto each end of AnoQuick holders, as shown.

Step 4 Attach top AnoQuick holder onto vertical poles.

- Slide one threaded rod with ball knob through top hole in one vertical pole.
- Slide threaded rod completely through top channel of one AnoQuick holder and through top hole of second vertical pole.
- Screw second ball knob onto other end of threaded rod. Tighten securely.

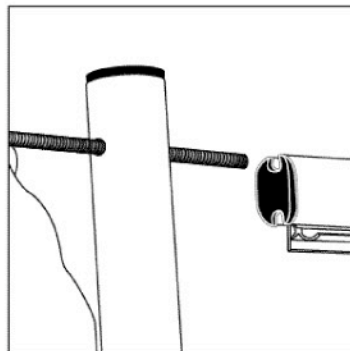

Slide threaded rod through the top hole of one vertical pole and then through top channel of one AnoQuick holder. Note: Picture shows Anogotcha. Assembly is the same.

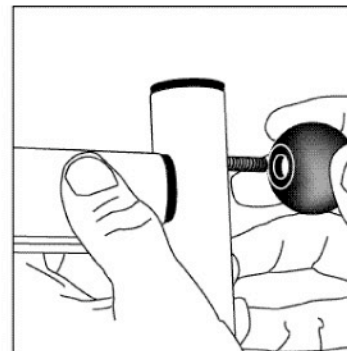

Slide threaded rod through top hole in second vertical pole. Screw ball knob tightly onto threaded rod.

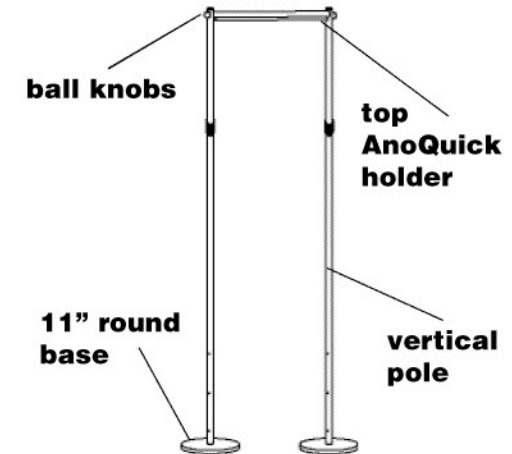

Your stand should now look like this.

Telescoping AnoGotcha™ Stand *assembly continued*

Step 5 Attach bottom AnoQuick holder to vertical poles.

- Choose hole that matches appropriate graphic distance from floor.
- Slide one threaded rod with ball knob through appropriate hole in one vertical pole and through bottom channel of one AnoQuick holder.
- Slide through corresponding hole of second vertical pole.

Note:

Graphics show AnoGotcha holders. Since you are using AnoQuick holders with Dowels, you will not have the T-Gotcha.

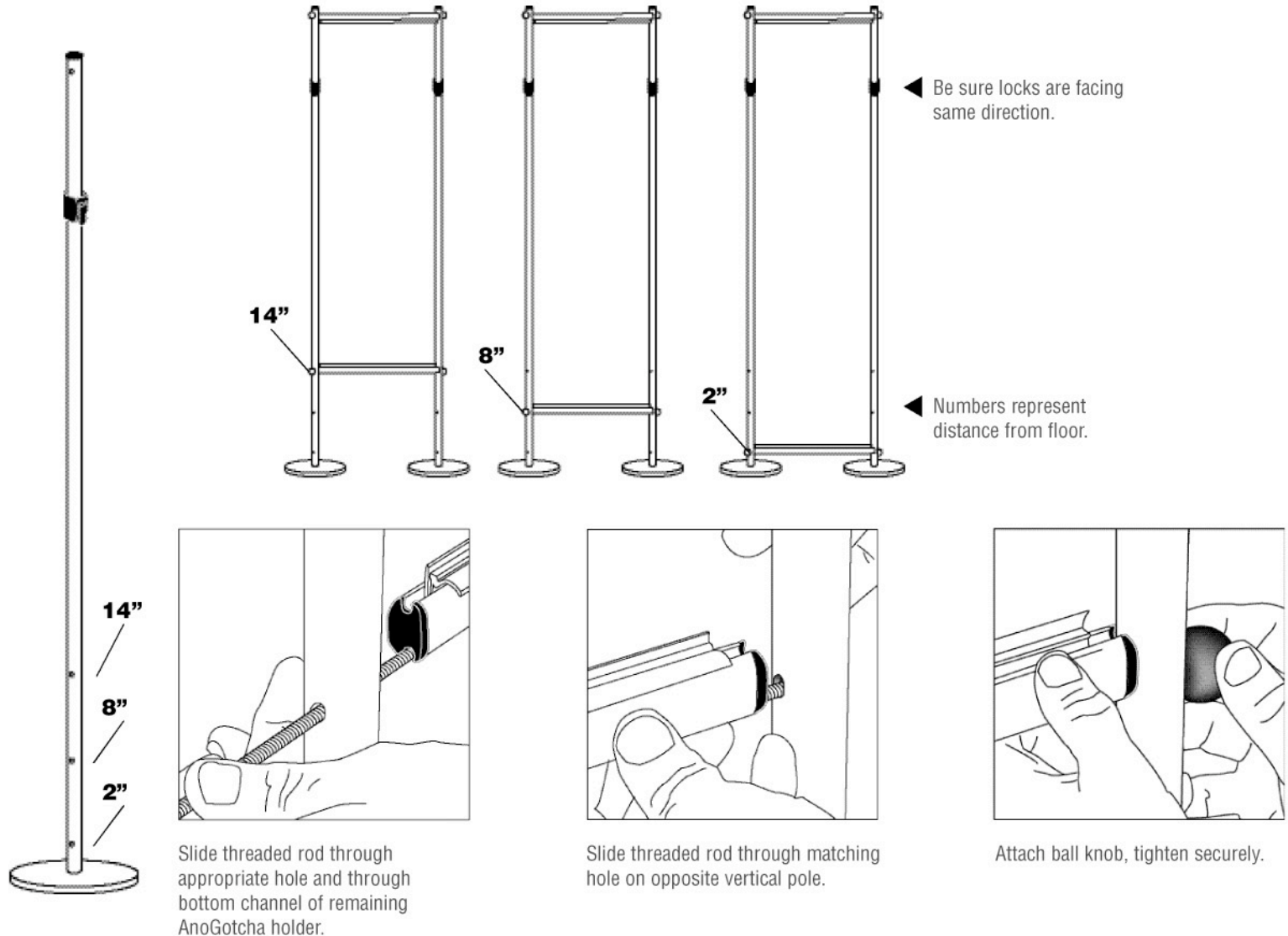

Telescoping AnoGotcha™ Stand *assembly continued*

Step 6 Open locks, raise top bar to tension graphic, snap locks closed.

- Open locks on both poles.
- Raise top bar to tension graphic.
- Snap locks closed.

Your AnoGotcha stand is now complete and ready for display.

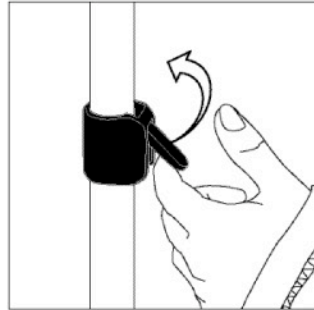

Open locks on both poles.

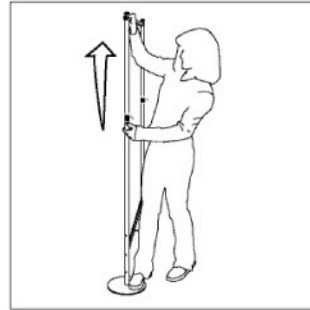

For each pole, place foot on base and raise top bar to tension graphic.

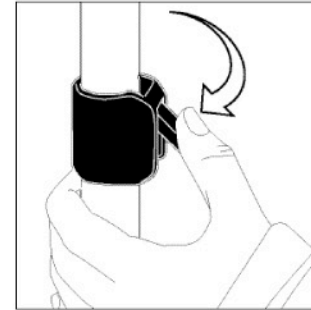

Close locks on both poles.

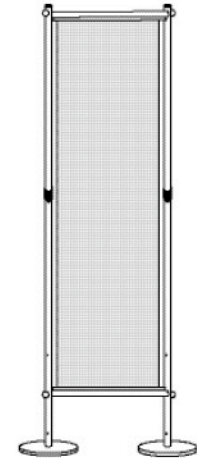

Your completed Telescoping AnoGotcha Stand should look similar to this.